



# Air Purifier

## Dear User

Thank you for joining us. Please read the manual thoroughly and follow the instructions step-by-step to get the best printing experience.

## 親愛的使用者您好

非常開心您的加入，為了您良好的使用體驗，請務必詳閱說明書。



# Introduction | 產品介紹

## PART.1

Top Cover  
上蓋

## PART.2

Power Switch  
電源開關

## PART.3

LED Indicator  
指示燈

## PART.4

Charging Port  
充電孔

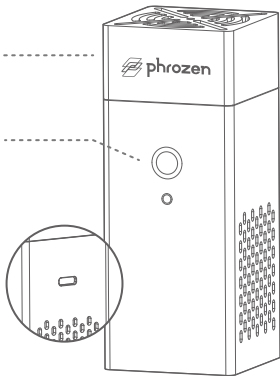

Activated Carbon Filter  
活性炭濾心



Air Purifier  
空氣清淨機



Charging Cable  
充電線

## Product Specifications 產品規格

機器尺寸 | Product Size | 115 x 46 x 46 mm

濾心尺寸 | Activated Carbon Filter Size | 39 x 39 x 18 mm

電池容量 | Battery Capacity | 2000 mAH

輸入電壓 | Input | DC 5V

額定功率 | Power | 0.6W

## User Guide | 使用說明

- 1 Open the air purifier cover, place the activated carbon filter inside, and secure the cover.
  - 2 Use a USB Type-C cable to charge the device. The breathing light indicates charging and turns off when fully charged.
  - 3 Turn on the device, ensuring the indicator light is green. Place it under the UV cover in the printer.
- 1 打開空氣清淨機上蓋，放入活性炭濾心並蓋緊上蓋。
- 2 連接充電線，指示燈顯示呼吸綠燈即為充電中，燈滅即完成充電。
- 3 開啟空氣清淨機電源，確認指示燈顯示綠燈，即可放入您的3D列印機中。

- Light On : Turn on / 機器正常運轉
- Light Breathing : Charging / 充電中
- Light Off : Low battery / 電量不足

### NOTICE ⚠ 注意事項

- Replace the activated carbon filter every 3–6 months for the best result.
  - DO NOT** turn on the device while it is charging to prevent damage.
  - For safety, keep the device and its accessories out of the reach of children.
  - Expose the used filter to sunlight or place it in a well-ventilated area to dissipate odors.
  - The included power cord set packaged with the main unit cannot be used with electrical equipment other than the specified device.
- 每3-6個月需定期更換活性炭濾心，以保持空氣清淨機的效能。
- 充電中請勿開啟空氣清淨機，避免造成損壞。
- 請將機器及配件放置於兒童觸碰不到的地方。
- 短期內，可將使用過的活性炭濾心放至陽光下曝曬、或置於空氣流通處，揮發吸附的異味。
- 機台附帶的電源線組只能與指定的電器設備一同使用，不得與其他電器設備搭配使用。

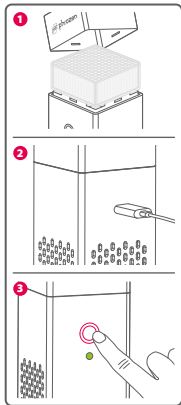

## Hazardous Substances 產品有毒有害物質元素清單

| Part 部件                      | Pb 鉛 | Hg 汞 | Cd 鎘 | Cr(VI) 六價鉻 | PBB 多溴聯苯 | PBDE 多溴二苯醚 |
|------------------------------|------|------|------|------------|----------|------------|
| Plastic Parts 塑膠物件           | ○    | ○    | ○    | ○          | ○        | ○          |
| Metal Parts 金屬物件             | ×    | ○    | ○    | ○          | ○        | ○          |
| Circuit Board Assembly 電路板組件 | ×    | ○    | ○    | ○          | ○        | ○          |
| Cables and Wires 線材類         | ×    | ○    | ○    | ○          | ○        | ○          |

### This table is made according to SJ/T 11364.

○ : Indicates that the concentration of hazardous substance in all of the homogeneous materials for this part is below the limit as stipulated in GB/T 26572.

× : Indicates that the concentration of hazardous substance in at least one of the homogeneous materials used for this part is above the limit as stipulated in GB/T 26572.

### 本表格根據SJ / T11364的規定編製

○ : 表示該有害物質在該部件所有均質材料中的含量均在GB/T26572-2011規定的限值要求以下。

× : 表示該有害物質至少在該部件的某一均質材料中的含量超過GB/T26572-2011規定的限量要求。

## Phrozen 3D Printer

🌐 phrozen3d.com ☎ +43-1-997809410 / +886-3-621-0505

📍 3F., No.287, Niupu Rd., Xiangshan Dist., Hsinchu City 30091, Taiwan



APEX CE SPECIALISTS LIMITED  
Unit 3D North Point House, north Point Business  
Park, New Mallow Road, Cork, T23 AT2P, Ireland  
Tel: +353212066339  
E-Mail: info@apex-ce.com



APEX CE SPECIALISTS LIMITED  
89 Princess Street, Manchester, M1 4HT, UK  
Tel: +441616371080  
E-Mail: info@apex-ce.com